

TECHNICAL GUIDE
LED Leuchtdisplay Convex, P516

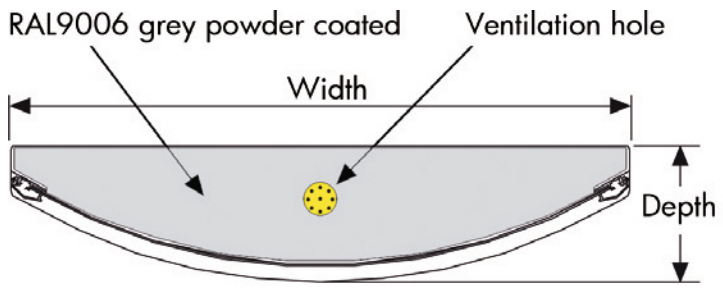

Print Material:
 We recommend
 Backlit Solvent



Now with LED

🇬🇧 Single sided light box with 25 mm alu snap-frames on the two long sides of the light box, which enable you to change the display material easily. Supplied with anti-reflex APET cover and back plate in 3 mm white opal acrylic. 230V and 2,5 metres cable. Only for indoor use.

🇩🇪 Einseitiger Leuchtkasten mit 25 mm Alu Profile. Klapprahmen an den Seiten vereinfacht das Wechseln der Poster. Entspiegelte antireflex APET Frontscheibe und Rückplatte aus 3 mm Opalweissem Acryl. 230V und 2,5 M Kabel. Nur für den Innenbereich.

🇩🇰 Enkelt-sided lyskasse med 25 mm alu snap-frames på lyskassens langsider, gør det muligt for dig let at udskifte budskabet. Convex Light-box leveres med APET antireflex frontplader og bagplade i 3 mm opal hvid akryl. 230V og 2,5 m kabel. Til indendørs brug.

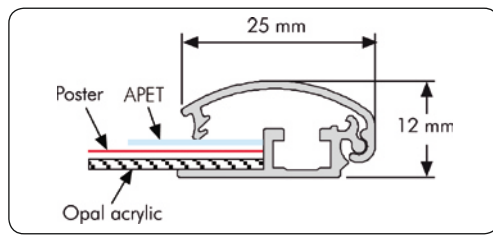
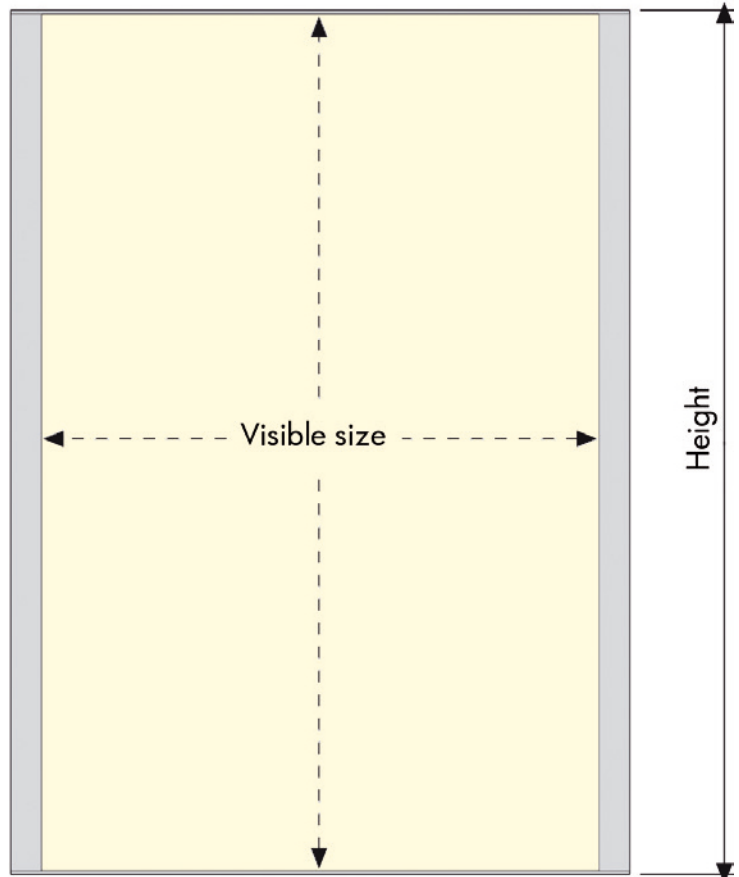

Model	Art.no.	Poster size	- visible part	Colour	Power	Total W x H	Package size and weight	Pallet size and quantity
516	4660	29,7 x 42 cm	A3 27,5 x 42 cm	Alu	1 x 8 W	32,6 x 42 cm	34 x 45 x 10 cm 4,0 kg	80 x 120 x 220 cm 62 pcs.
-	4661	42 x 59,4 cm	A2 38,9 x 59,4 cm	-	2 x 15 W	44,9 x 59,4 cm	45 x 63 x 11 cm 4,5 kg	80 x 120 x 220 cm 47 pcs.
-	4663	50 x 70 cm	47,8 x 70 cm	-	2 x 18 W	52,9 x 70 cm	53 x 73 x 12 cm 5,0 kg	80 x 120 x 220 cm 30 pcs.
-	4662	59,4 x 84,1 cm	A1 57,2 x 84,1 cm	-	2 x 18 W	62,3 x 84,1 cm	63 x 88 x 13 cm 12,0 kg	80 x 120 x 220 cm 19 pcs.

TECHNICAL GUIDE

LED Leuchtdisplay Convex, P516



- Open all profiles.
- Alle Profile in der Pfeilrichtung öffnen.



- Take-off the anti-reflex cover.
- Antireflex -Schutzfolie abheben.



- For mounting on the wall please use the key holes at the back.
- Der Convex Leuchtkasten ist durch die Bohrungen an der Rückseite durch Verwendung von Dübel und Schrauben an die Wand zu hängen.

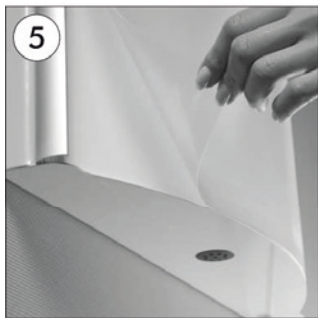
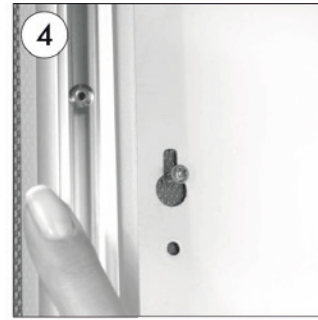

- Close the side profiles with the replacing of plexi backing, poster and the PVC cover.

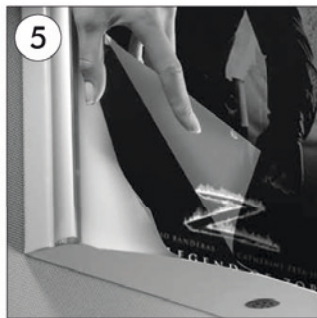

- Klappen Sie die Seiten-Klapprahmen zu, nachdem Sie die opal Scheibe, Ihr Poster und die Schutzscheibe eingelegt haben.

